

szuk 1

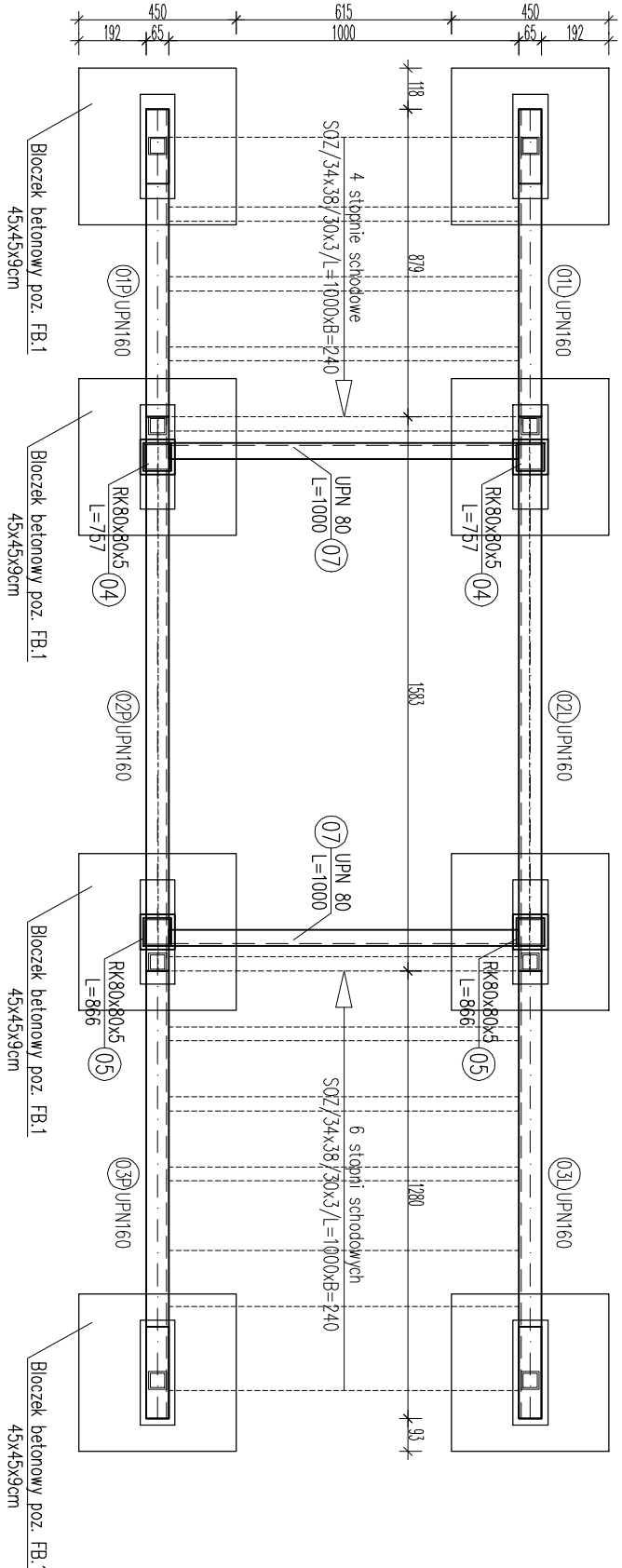

Stal S235Jf, elektrody ER-146 lub spawanie Mg-MAG

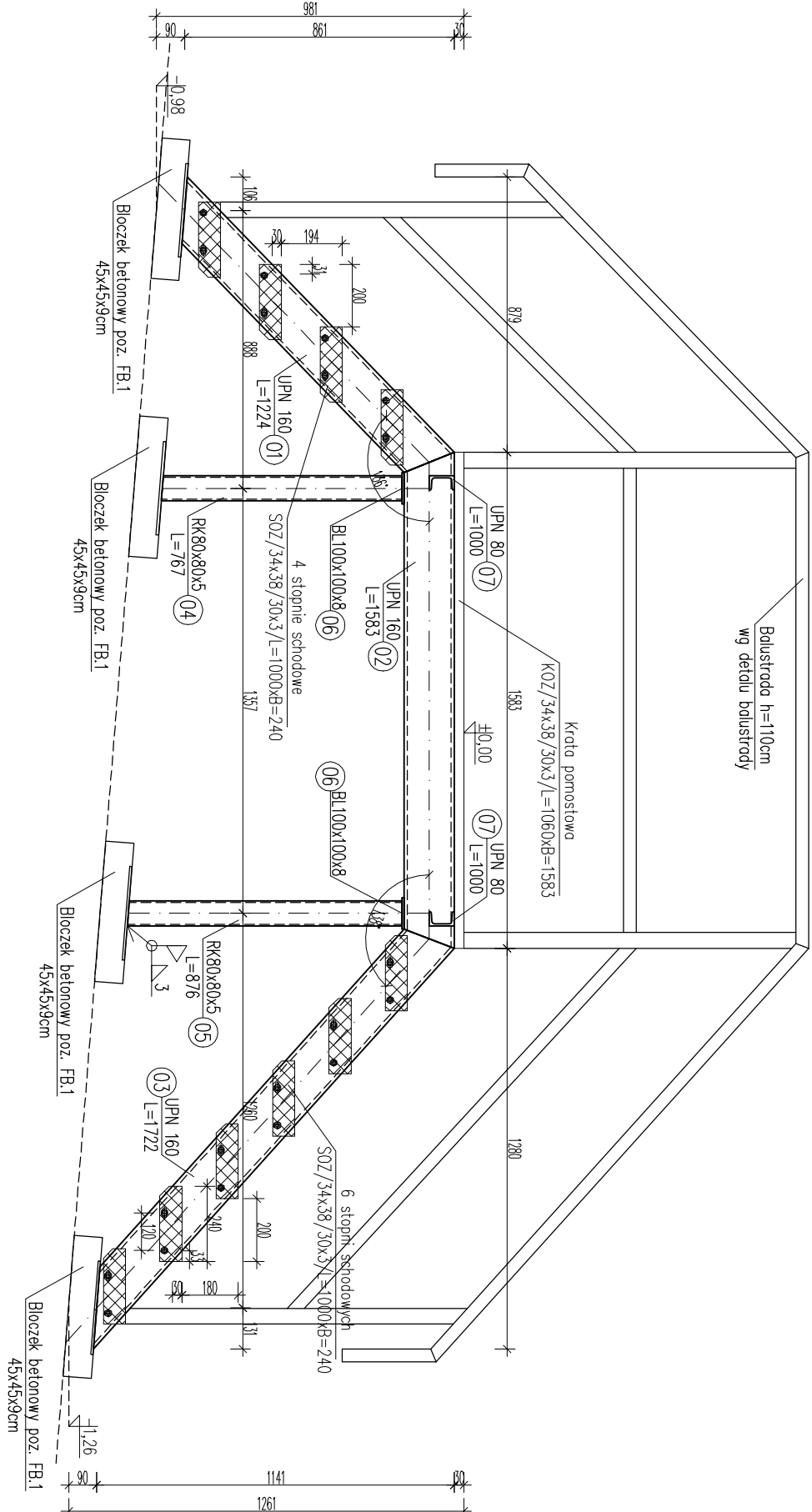
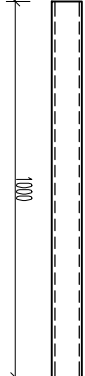
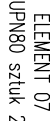
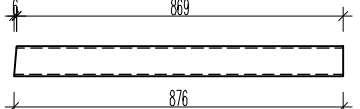
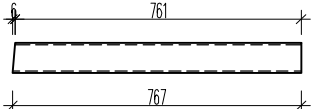
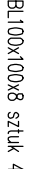
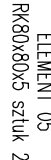
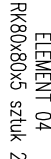
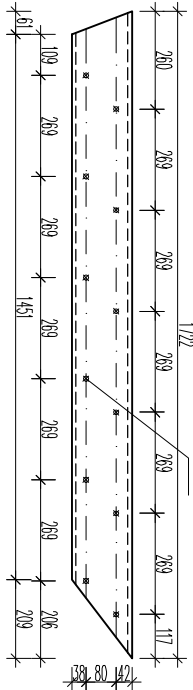
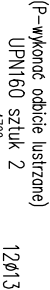
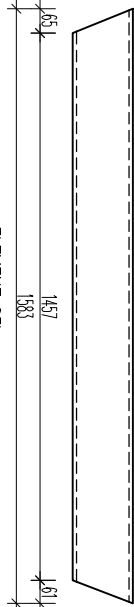
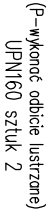
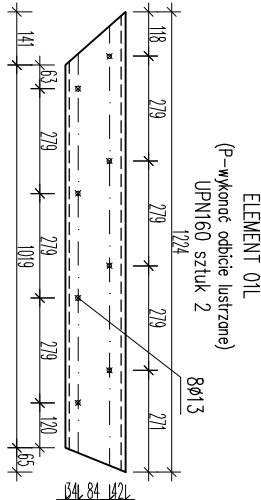

POMOST TECHNICZNY NR3 NA DACHU BUDUNKU "D"

SKALA 1:20

<div></div> <div><p>PRZEDSIĘBIORSTWO PROJEKTOWO-REALIZACYJNE BUDOWNICTWA „PION” SP. Z O.O.</p><p>ul. Paderewskiego 10/2, 85-075 Bydgoszcz</p></div>			
<p>Inwestor:</p> <p>KULAWSKO POMORSKIE CENTRUM PULMONOLOGII W BYDGOSZCZY , ul. Seminarzysta 1</p>	<p>Branża:</p> <p>KONSTRUKCJA</p>		
<p>Temat: PROJEKT POMOSTÓW TECHNOLOGICZNYCH NA DACHU BUDYNKU "D" KULAWSKO POMORSKIEGO CENTRUM PULMONOLOGII W BYDGOSZCZY , ul. Seminarzysta 1</p>	<p>Data:</p> <p>17.09.2018</p>	<p>Faza:</p> <p>PW</p>	
<p>Rysunek:</p> <p>Pomost techniczny 03</p>	<p>Nr zlecenia:</p>	<p>Skala:</p> <p>1:20</p>	
<p>Projektował:</p> <p>mgr inż. Jerzy Prywiński upr. nr GTIIL-7210/18277</p>	<p>Nr. rys.</p> <p>K-4</p>		
<p>Opracował:</p> <p>mgr inż. Wojciech Rogalski</p>			